



Peter James Lee Small Church Revitalization
Application Cover Sheet

Date: 18 March 2022

Applicant Information

Church: Church of the Good Shepherd

Address: 27 Good Shepherd Road (P.O. Box 324), Bluemont, VA 20135

Phone: 540-252-5825 Fax: N/A Email: office@goodshepherdbluemont.com

Website: www.goodshepherdbluemont.com Region: Northern Shenandoah

Contact Person for Project

Name: Timothy Hall Title: Junior Warden

Address: 2032 Arch Drive, Falls Church, VA 22043

Phone: 540-454-0564 Fax: N/A Email: timhall100@aol.com

Project Information

Project Title: Prayer and Meditation Garden

Brief Project Description (40 words maximum): Establish a plan and initiate establishment of a garden space with attention to erosion and runoff control using native, non-invasive plantings and plants for pollinators that will provide a spiritual space for communing with our Creator.

Amount Requested: \$ 4,222 Total Project Budget: \$ 8,444

Required Documentation Provided

By signing below you verify that all documents listed below are complete and enclosed. You also certify that all required annual Diocesan parochial reports have been submitted. Proposals submitted with incomplete documentation or reports may be returned.

Proposal Information

- Cover Sheet
- Narrative
- Project Budget
- Project Timetable
- Current operating budget for applicant entity
- Most recent audited financial statement for applicant*
*(please include a copy with your proposal)

Diocesan Reports

- All required parochial and financial reports have been submitted.
- We have submitted a 2022 financial pledge to the Diocese of Virginia.

We have received a Peter James Lee Small Church Revitalization grant in the past.

If so, what year(s): 2017

Our final report(s) have been submitted to the Diocese of Virginia

(Please note: Final reports from previous Peter James Lee Small Church Revitalization grants must be on file with the Diocese of Virginia before new proposals will be considered.)

Two Signatures Required

[signed Electronically]

Rector/Vicar/Priest-in-Charge/Sr. Warden

Lois Tapscott, Senior Warden

Print or Type Name and Title

[you may include this information in an email if signing a hard copy poses difficulties]

[signed Electronically]

Senior Warden/ Treasurer

Cindy Ingram, Treasurer / Project Lead

Print or Type Name and Title

Submit complete grant application no later than March 18, 2022 to:

Stephanie Gurnsey Higgins
Diocese of Virginia
PO Box 27426
Richmond, VA 23261

Project Narrative

The congregation of Good Shepherd is undertaking a capital effort in 2022 to create a Prayer and Meditation Garden on the east slope of our church property. This project will make our outdoor spaces more appealing and welcoming to newcomers, community groups, and wildlife, will support our ministry and outreach efforts, and will further our efforts in creation care. Our little church is literally on the side of a mountain, little more than a stone's throw from the Appalachian Trail. This year we will develop a plan and initiate the establishment of the garden space, with attention to erosion and runoff control, using native, non-invasive flora and pollinator plants that will provide a spiritual outdoor space. This is an ambitious undertaking that may span several years. The majority of the planning, layout, landscaping, and cost will take place this year, with additional plantings and enhancements in subsequent years.

The technical part of the project is being led by Cindy Ingram, a member of our vestry who graduated from JMU last May with a double major in Biology and Religion. She is currently pursuing a Master of Divinity at Candler School of Theology via their remote education program. Cindy has worked with flora extensively through internship with the Virginia Chapter of the American Chestnut Foundation, and as part of a research team that tested for best practices for forest plantings. Cindy's draft plan for the Prayer and Meditation Garden is shown in Figure 1 on the next page.

Tim Hall, our Junior Warden, will lead the programmatic side of the project, having responsibility for fundraising, soliciting community involvement, ensuring project bills are paid, and coordinating events such as ribbon cutting and consecration. Tim did project and program management in the private sector for the latter two decades of his career. A project committee is being formed from members of the congregation, which will provide assistance with securing community involvement through volunteer opportunities and fundraising efforts for the project.

Our hope and dream is to attract more of our community to use our church as a place of prayer and meditation, especially when they are in need: a place to be outside in nature, quiet and close to home. We will invite local and/or school organizations to help with outreach labor on this project, hoping thereby to foster deeper community relationships. Cindy, along with other interested parishioners, has already met with Stacey Remick, chair of the DOV Creation Care Task Force, to walk the planned garden area and get her input about preliminary design ideas.

This garden is a natural extension of our sweet chapel, built as a mountain mission church in 1909, and the outdoor Stations of the Cross pathway, built as an Eagle Scout project in 2011. The pathway starts on the back patio of the church, winds its way through the woods up a gentle slope, to culminate at the cross, near where the Prayer and Meditation Garden is planned. The garden will enhance Good Shepherd's mission to be a place for the community to worship, pray, and be with God.

We respectfully request financial support from the Diocese through the Bishop Peter James Lee Small Church Revitalization grant program, hoping this grant will provide 50% of our funding requirement. We will raise the necessary additional one-for-one funding primarily through donations by church members and close friends of the church, with additional support sought from local businesses and parish fundraising events, which will help build community support and enthusiastic parishioner involvement, and use of funds from our existing building account. Our preliminary budget for this project is \$8,444, which includes \$4,944 for plants and landscape materials and \$3,500 in hired professional labor for site work, including tree work, rock removal, and soil amendment and preparation, with heavy equipment. Further details are included in the Project Budget section below.

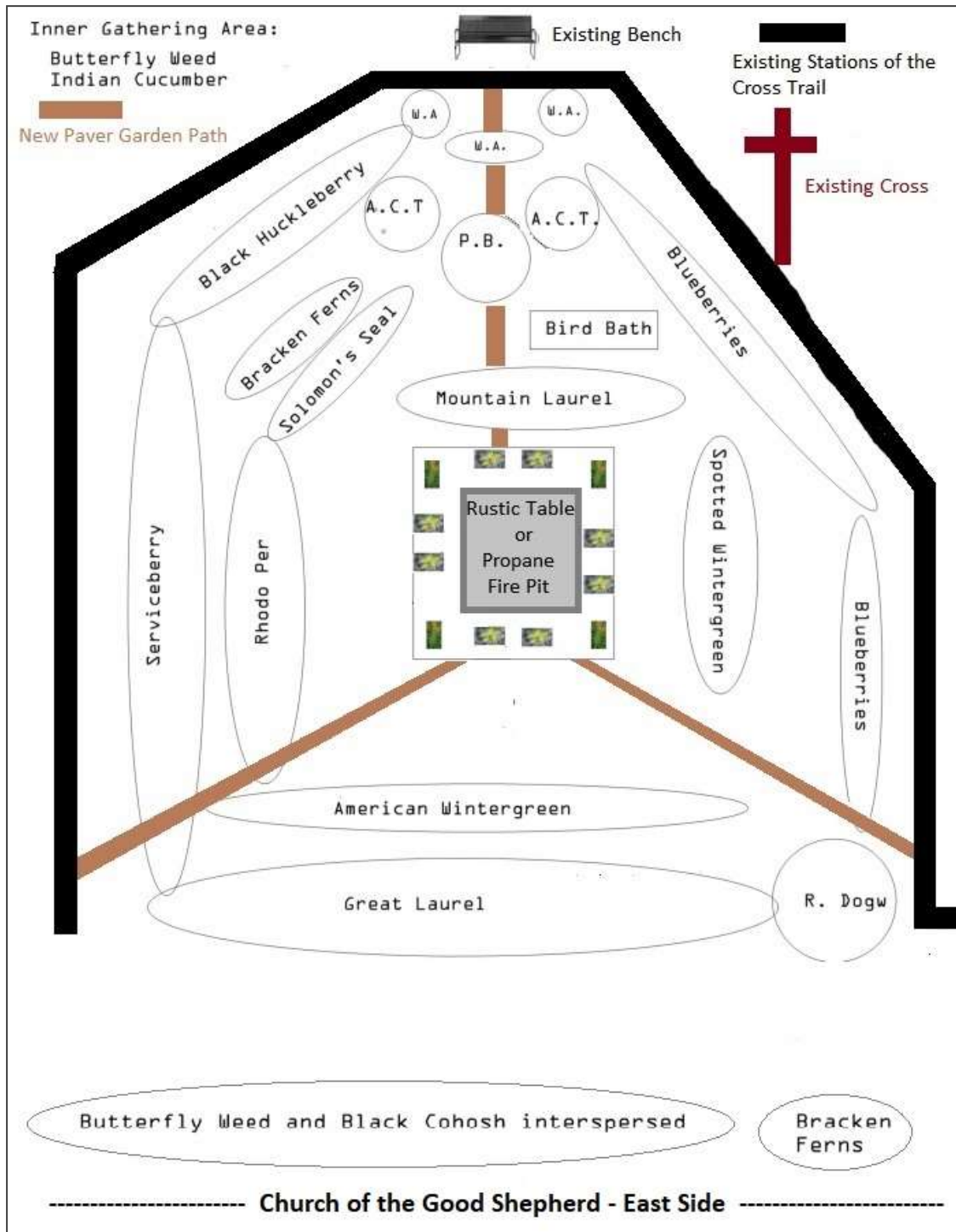

Figure 1. Preliminary Garden Layout

Good Shepherd is a small mission church with limited financial capacity. We are exceedingly thankful to the Diocese for the support you have provided us over the years, especially for our annual Committee on Congregational Missions (CCM) support, allowing us to continue our 112 year tradition of glorifying God here on the slopes of the Shenandoah. We, in turn, have been faithful in our financial support to the Diocese, to the Northern Shenandoah Region, and in keeping our audits and parochial reports up-to-date.

We welcome outside groups for meetings in our church, and hope to reach even more groups at this charming location. We provide space for an Alcoholics Anonymous group that has been meeting in our parish hall every Saturday night for decades. Numerous weddings and other life events occur here, often for folks that are not closely associated with the church. We hope that this Prayer and Meditation Garden will draw even more people and organizations to use our church, both on a regular and as needed basis, and may help in congregational growth, as well. We would welcome additional vestry and/or other church groups, the CCM, the Northern Shenandoah Region, and other community groups to use our space.

The success of our project will be, first and foremost, a delightful addition to our outdoor space that provides multi-season blooming for pollinators, food for birds, enhanced erosion control, and a quiet space for communing with God in nature. Further success will be seen in Good Shepherd's growth as a soothing place for our local community to gather and a place from which we, as a church, can walk in love ministering to the needs of this community, welcoming friends and strangers alike.

For further information, please contact Cindy Ingram, our project lead, at cndyingram@cs.com or Tim Hall, grant coordinator, at timhall00@aol.com. The Rev Deborah Rutter and the Rev Martha Clark are our supply clergy and can be reached at revdeb3@gmail.com, or marthaekclark@gmail.com, respectively.

Project Budget

Project Expenses (detailed expenses shown on next page):

1. Herbaceous Plants	\$ 1,320.00
2. Shrubs and Trees	\$ 1,156.00
3. Two hybrid American Chestnut (complimentary)	\$ 0.00
4. Planting supplies	\$ 840.00
5. Landscape materials	\$ 1,628.00
6. Professional contracted site preparation (<i>For quote see attachment (1)</i>)	\$ 3,500.00
TOTAL Expenses	\$ 8,444.00

Project Revenues:

1. Existing Church Funds	\$ 3,000.00
2. Individual Monetary Donations	\$ 500.00
a. Funds received: \$ 0.00	
b. Funds pledged: \$ 0.00	
3. Business Monetary Donation	\$ 300.00
a. In process of identifying local businesses.	
b. Nothing received or promised to date.	
4. American Chestnut Tree donation	NC
5. Church members: time donations for planting & mulching	NC
6. Fundraising events	\$ 422.00
7. DOV Peter James Lee Small Church Revitalization Grant	\$ 4,222.00
TOTAL Revenues	\$ 8,444.00

Outside Organization: This project does not support any project for an outside organization. However we do hope to elicit help from outside organizations to help them meet their community service goals.

Estimated Prayer Garden Detailed Costs				
Wood Anemone (W.A.)	64	@	\$ 7.00	\$ 448.00
Bracken Ferns	10	@	\$ 10.00	\$ 100.00
Black Cohosh	20	@	\$ 4.00	\$ 80.00
ButterflyWeed	36	@	\$ 8.00	\$ 288.00
Indian Cucumber	16	@	\$ 11.00	\$ 176.00
Solomon's Seal	8	@	\$ 11.00	\$ 88.00
Partridge Berries (P.B.)	8	@	\$ 12.00	\$ 96.00
Spotted Wintergreen	8	@	\$ 5.50	\$ 44.00
Total Herbaceous		170		
Black Huckleberry	3	@	\$ 22.00	\$ 66.00
Mountain Laurel	2	@	\$ 60.00	\$ 120.00
Serviceberry	2	@	\$ 25.00	\$ 50.00
American Wintergreen	20	@	\$ 19.00	\$ 380.00
Redosier Dogwood (R. Dogw)	1	@	\$ 24.00	\$ 24.00
Great Laurel	3	@	\$ 60.00	\$ 180.00
Blueberry Bushes	10	@	\$ 30.00	\$ 300.00
Rhododendron p (Rhodo Per)	2	@	\$ 18.00	\$ 36.00
Total shrubs & trees		43		
Hybrid Chestnut Trees	2	@	\$ -	\$ -
50 pd Bag 10-10-10 Feilizer	1	@	\$ 20.00	\$ 20.00
4 pd Bag of Blood Meal	5	@	\$ 10.00	\$ 50.00
45 Tree and Shrub Shelters	45	@	\$ 2.00	\$ 90.00
100' Roll Plant Netting	1	@	\$ 180.00	\$ 180.00
Bulk Hardwood Mulch (cu. yds)	10	@	\$ 50.00	\$ 500.00
Stepping stones	200	@	\$ 1.58	\$ 316.00
Landscape Timber	50	@	\$ 5.68	\$ 284.00
St Francis Statue	1	@	\$ 399.00	\$ 399.00
Rustic Outdoor Table / Fire Pit	1	@	\$ 400.00	\$ 400.00
Bird Bath	1	@	\$ 229.00	\$ 229.00
Professional Contracted Site Preparation	1	@	\$ 3,500.00	\$ 3,500.00
(Includes the removal of all small trees & shrubs, snag removal and cutting into seating, and 2 dump loads of top soil)				
	Total			\$ 8,444.00

Project Timetable

Our plan for implementing this project is to accomplish as much of the site work as possible in the mild springtime weather this year, when the soil is more easily worked and before heavy growth overtakes the garden area. Initial planting will be done in the area closest to the church in order to establish an erosion barrier and to give those plants a full growing season. We will also plant the donated American Chestnut trees and the Dogwood so that they, too, can start getting established. As we line up community groups to participate in the project, we'll complete the layout over the Summer, using the landscape timbers, pavers, and twine to define the different garden areas based on our drawings. And

we'll build out our central gathering area. As the cooler weather approaches we'll line up more volunteers to help plant the shrubs, which will benefit from a fall planting, and also put down a good layer of mulch. Finally, in the Spring of 2023 we'll complete the planting with setting out the remainder of the herbaceous plants, giving them time to thrive, spread, and seed themselves.

In order to jump start this project, our initial effort this Spring will be funded from our existing building fund account. To supplement this, we will begin project fundraising right away. This will include direct mail and email appeals to membership and friends of the church, approaching local businesses for support, and scheduling and holding fundraising events, which have not yet been identified but may include bake sales, a yard sale, and ice cream social. Our garden consecration and ribbon cutting celebration will be planned as the project progresses and we'll be trying to entice many of our neighbors and local businesses to attend.

We are currently considering working with Chris Craven, a local landscape contractor, to do the initial site work. However, before proceeding with Craven Landscaping we will obtain at least one more quote for services. Plants will be purchased from local nurseries and landscape material purchased at best available rates. We hope to provide the opportunity to local groups to help with the layout, planting, and mulching and will be approaching the Clarke County school system to see if there are any groups looking for service projects, the Boy Scouts and Girl Scouts, and other local church and/or civic youth groups that may come to mind.

Current operating budget

Our 2022 budget was submitted to the CCM as part of the Mission Financial Status & Request for Aid in 2022, on 1 August 2021. The CCM approved a different aid amount from what we requested. This modified budget, reflecting the different aid, is included as Attachment 2.

Most recent audited financial statement

Good Shepherd Church has submitted audits, using the Audit Program Checklist, every year. Our most recent audit was done for year 2020 and was submitted to the Diocese on 31 August 2021. A copy of the 2020 audit short form (without enclosures) is included as Attachment 3.

Record of parochial reports

Good Shepherd Church has an ongoing three-year history of submitted parochial reports. Our parochial reports for 2021, 2020 and 2019 have all been submitted, with the 2021 report submitted on 28 February 2022.